

# flexiguide

## Product Specification

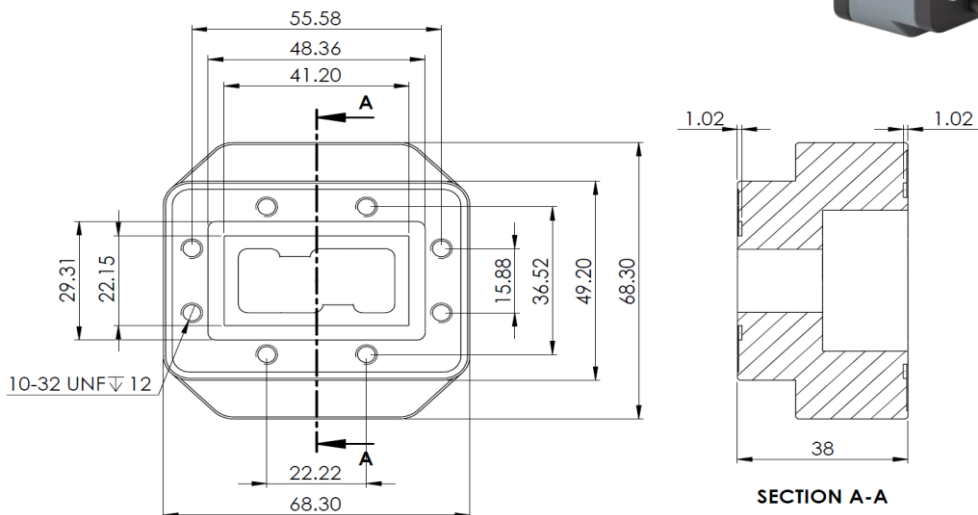
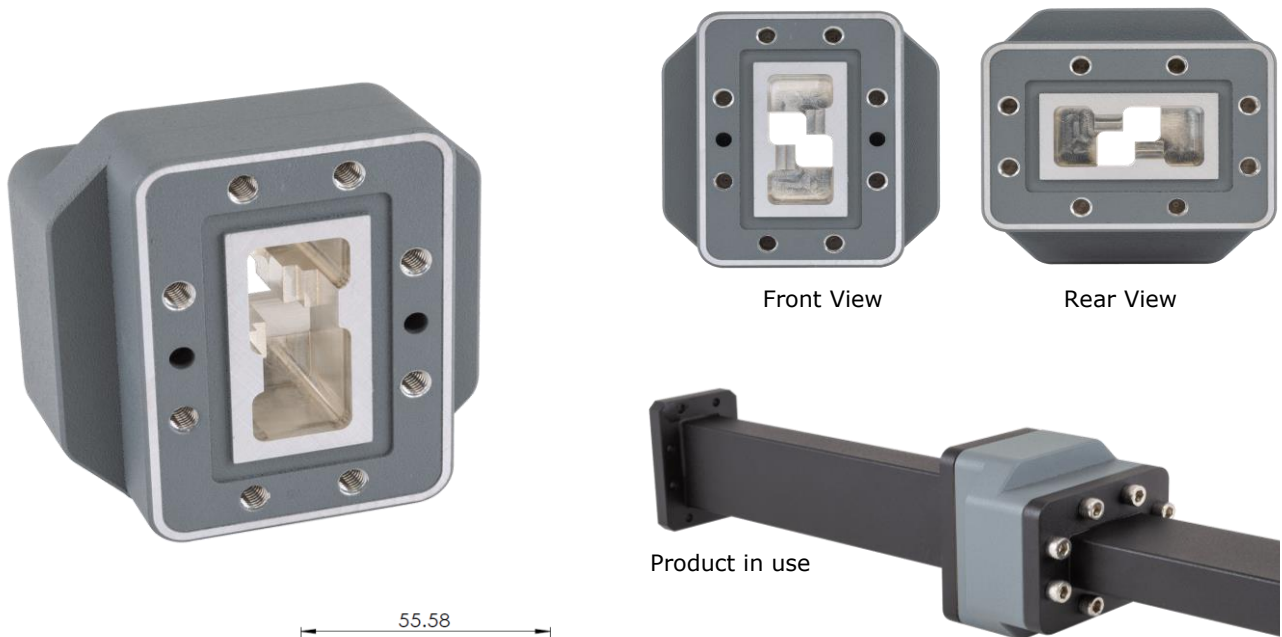

**Part Number:**

**ST14CC-90-P-\***

\* = see options below

### Description / Mechanical Specifications

Product Type:	Waveguide Twist (Super-Twist)
Waveguide Size:	WG14 / WR137 / R70
Flange 1:	14C (CPR137G)
Flange 2:	14C (CPR137G)
Twist Angle:	90°
Material / Finish:	Aluminium / Passivated
* Paint Finish:	G = Gray (RAL 7012), B = Black, W = White
Accessories:	None

### Electrical Specifications

Frequency Range:	5.85 - 8.20 GHz
Insertion Loss:	0.1 dB
Return Loss:	29.4 dB

### Environmental Performance

Temperature Range:	-70 to +150°C
ETSI Class:	ETSI EN 300-019-2-4 Class 4.1
I.P. Rating:	IP65 (Weatherproof)